



PCM160 (former PT970)

PRESSURE & TEMPERATURE SENSOR



- ▶ **Combined Pressure and Temperature**
- ▶ **Built in Electronic with Vdc Output**
- ▶ **All Stainless Steel Construction**
- ▶ **Temperature Output Direct from P100 or PT1000**
- ▶ **High Temperature Capability : -40 to +125°C**

MINIATURE

Technical Specifications	PCM163	PCM164	PCM167
Pressure Ranges (FS)	3 / 5 / 10 / 20 / 40 / 100 / 250 / 400 / 600bar -1/+2bar; -1/+3bar; -1/+5bar		
	40 / 70 / 150 / 300 / 500 / 1500 / 3000 / 5000 / 8000PSI -14,5/+30PSI; -14,5/+40PSI; -14,5/+70PSI		
Type	Absolute, Gage, Sealed Gage (for ranges > 40bar)		
Safe Overload / Burst Pressure	150%FS / 300%FS		
Power Supply	5Vdc ± 10mV	8 to 30Vdc	8 to 16Vdc
Consumption	< 10mA		
Output at -100%FS (only for ± range)	0,5Vdc	Proportional to +100%FS	0,5Vdc
Output at 0%FS	0,5Vdc	0Vdc	0,5Vdc
Output at 100%FS	4,5Vdc	5Vdc	4,5Vdc
Zero and Sensitivity settings tolerances	± 50mV		
Combined Non Linearity & Hysteresis (P)	± 0,25%FS		
<i>Option</i>	± 0,1%FS		
Thermal probe	PT100 Class A		
<i>Option</i>	PT1000 Class A		
Combined Non Linearity & Hysteresis (T°C)	± 0,1%FS max.		
Non Repeatability	± 0,02%FS typ.		
Signal Bandwidth (electronic)	1000Hz @ -3dB		
Insulation	> 1000MΩ @ 50 Vdc		
Compensated Temperature	-25 to +85°C / -13 to +257°F		
<i>Option</i>	-40 to +125°C / -40 to +257°F		
Operating Temperature	-40 to +125°C / -40 to +257°F		
Combined thermal zero & sensitivity shifts	± 2.10 ⁻⁴ FS/°C		
<i>Option</i>	± 1.10 ⁻⁴ FS/°C		
Long Term Stability	± 0,1%FS/year typ.		
Constant acceleration in linear vibrations	± 0,02%FS/g (frequency 20-2000Hz, 50g max.)		
Mechanical Shock	100g ½ sinus 1ms		
Electrical Protection	Protected against polarity inversion		
EMC Protection	Compliant to EN61000		
Standard Electrical Connection	1m Teflon Jacketed Shielded Cable Ø3,4mm, 5 wires AWG26 MIL-C26482 (6 pins) receptacle		
Standard Mechanical Connection	M10x1 male		
<i>Option</i>	-		
Material(s) of Wetted Parts	Stainless Steels 316L (1.4404), 15-5PH (1.4545) and 17-4PH (1.4542)		
Weight	< 30g without cable		
Enclosure Protection	IP65 for Sealed Gage & absolute		
Accessories delivered with the sensor	Viton O-ring 7,65x1,63 (standard)		
	Calibration certificate, Datas in pressure and temperature		



E.F.E.

L'Essor Français Electronique

Head Office: 16 rue Porte à Bateaux – 27540 Ivry la Bataille – France

Tel: 33 (0)2.32.22.35.05 – Fax: 33 (0)2.32.36.93.08 – www.efe-sensor.com



PCM160

**PRESSURE & TEMPERATURE SENSOR
CAPTEUR PRESSION & TEMPERATURE**

PLAN / DRAWING

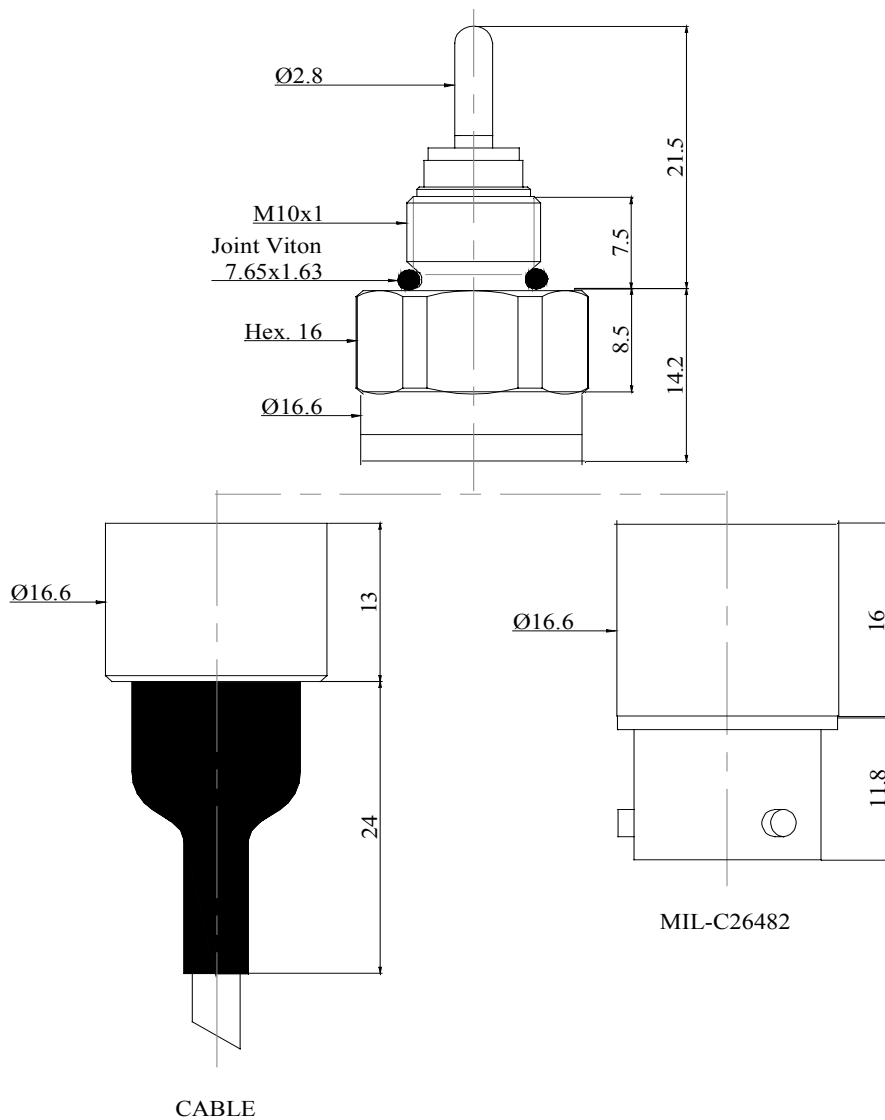

SCALE 1:1

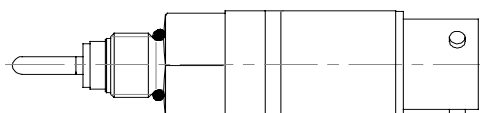

E.F.E.

L'Essor Français Electronique

Head Office: 16 rue Porte à Bateaux – 27540 Ivry la Bataille – France
Tel: 33 (0)2.32.22.35.05 – Fax: 33 (0)2.32.36.93.08 – www.efe-sensor.com





PCM160		ORDER CODE								
Complete Reference		PCM16 X - X - XXX - XXX - XX - XX - XX - X XX - XX								
Model	Pressure sensor for Combined Measurements Ø 16,6mm	PCM								
		16								
Output Signal	0,5-4,5Vdc (ratiometric)									
	0-5Vdc									
	0,5-4,5Vdc									
Material of wetted parts	Stainless Steel									
Pressure Ranges	Unidirectional example : 20bar									
	Bidirectional example : -1/+4bar									
Pressure Unit	bar									
	PSI									
Operational Mode	Gage									
	Sealed Gage									
	Absolute									
Mechanical Thread	M10x1 male									
Electrical Connection	Teflon cable output X meter(s)									
	MIL-C26482 (6 pins)									
Compensated Temperature	-25 to +85°C / -13 to +257°F									
	-40 to +125°C / -40 to +257°F									
Accuracy	± 0,25%FS (Standard)									
	± 0,1%FS (Option)									
Thermal Shifts	± 2.10 ⁻⁴ FS/°C (Standard)									
	± 1.10 ⁻⁴ FS/°C (Option)									
Options	N/A									
	EPDM O'ring									
	Specific Settings									
	Specific Marking									
	PT1000 Thermal Probe									

00
E
S
G
C



E.F.E.
L'Essor Français Electronique
 Head Office: 16 rue Porte à Bateaux – 27540 Ivry la Bataille – France
 Tel: 33 (0)2.32.22.35.05 – Fax: 33 (0)2.32.36.93.08 – www.efc-sensor.com